

RECOMMENDED $D > 100$ [4].
MIN. $D = 50$ [2] REQUIRES
SPECIAL CONFIG. SETTINGS.

MAX REC. $H < (D + 100)$ [D+4].

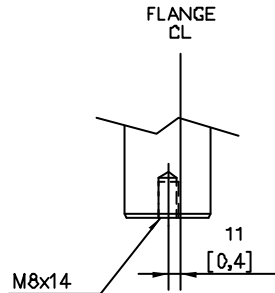

DEPENDING ON TURBULENCE IN TANK
AND MOUNTING ANGLE THE PROBE MAY
NEED TO BE ANCHORED OR SUPPORTED.

ENSURE MID PROBE HAS NO CONTACT
TO WALL. MIN DISTANCE 15 [0,6].

FOR MORE INFO. SEE
REFERENCE MANUAL

① P/T-RATING FOR FLANGE; SEE REF. MANUAL.

04	GASKET	1	ACC. TO BSP-G THREAD STD.	CUSTOMER
03	GASKET	1	SOFT GASKET T=MIN 1,6 (ANSI B16.5/1A, EN1514-1/IBC) SEE NOTE 1	CUSTOMER
02	SCREW/NUT/WASHER	-	ACC. TO FLANGE STD. SEE NOTE 1.	CUSTOMER
01	FLANGE	1	DIM. ACC. TO ANSI B 16.5/ EN 1092-1. OTHER ON REQUEST. P/T-RATING SEE NOTE 1.	RMT
POS	ITEM DESCRIPTION	QTY	REMARK	SUPPLIER

ISSUED BY	WEEK	PRODUCT CODE	FILE	INSTALLATION DRAWING TITLE	
GU-TK-RS	0218	3300	IDEAS	MECHANICAL INSTALLATION DWG	
APPROVED BY	WEEK	ORIGINAL DWG NO.	SCALE	FLEXIBLE TWIN LEAD, SERIES 3300	
GU-HF	0220	9150077-971	1:4		
SAAB ROSEMOUNT		1 ST ANGLE	DWG TYPE	DWG NO.	ISSUE
			2	9150077-971	2
					01/01

THE COPYRIGHT/OWNERSHIP OF THIS DOCUMENT IS AND WILL REMAIN OURS. THE DOCUMENT MUST NOT BE USED WITHOUT OUR
AUTHORIZATION OR BRUGHT TO THE KNOWLEDGE OF A THIRD PARTY. CONTRAVENTION WILL BE PROSECUTED. SAAB MARINE ELECTRONICS AB.